



405/101 Church Street Ryde, NSW



Available now! 2 Bedroom Apartment with Beautiful Sky and Green Views for lease!

Great light-filled in, enjoy whole day sun light in living, kitchen and bedrooms with nice sky and green views.

Walking distance to Meadowbank station, Ferry, Top Ryde Shopping Centre and Meadowbank Public School.

Ryde Park and Lane Cove National Park are in close proximity. Conveniently located near the Ryde Aquatic Centre, Rhodes Waterside Shopping Centre, Macquarie Shopping Centre and Eastwood Central.

Features:

- Timber floor throughout, easy to maintain!
- Security intercom & lift access.

Alex Bi

0401 022 086

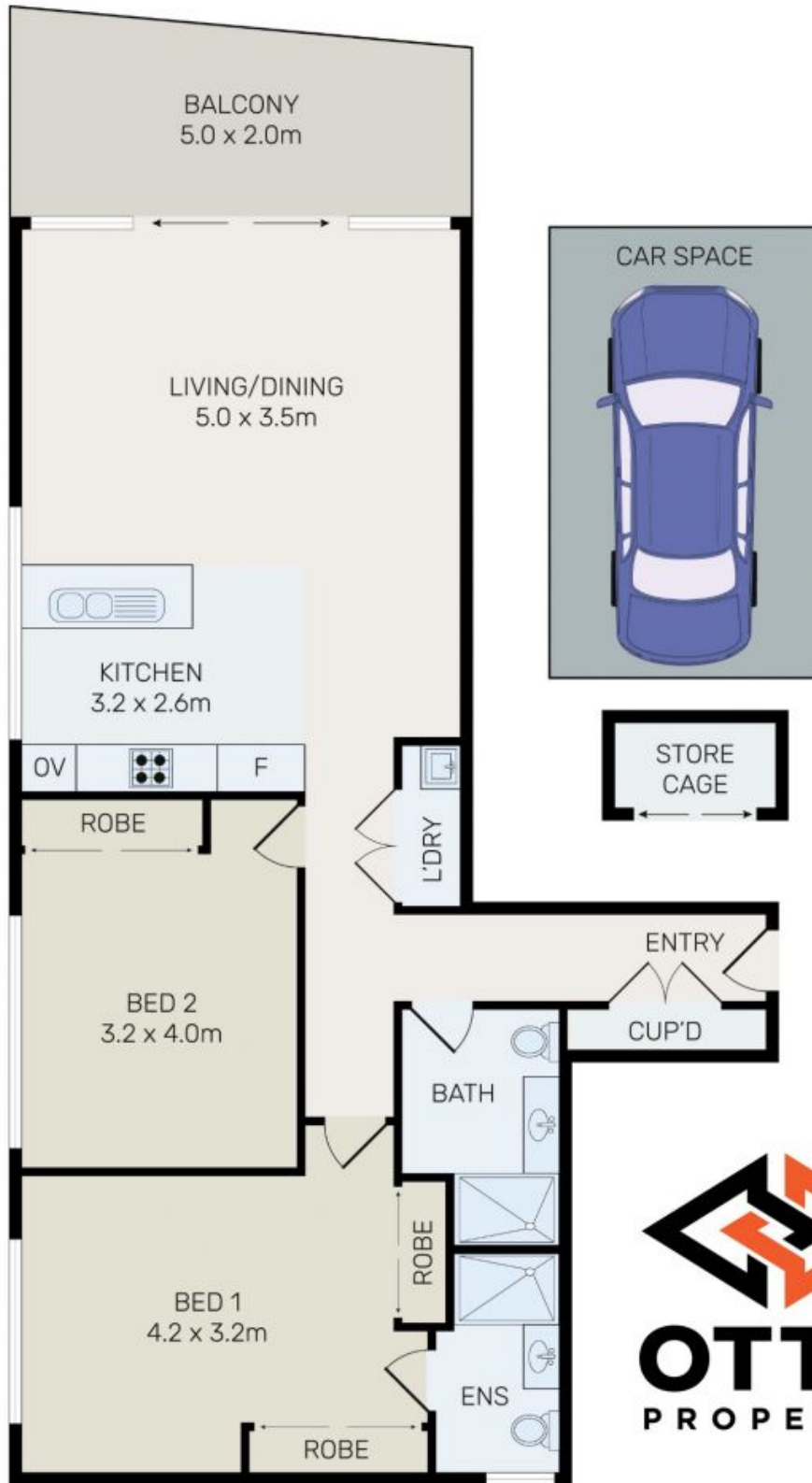

All information contained herein is gathered from all sources we believe to be reliable. However we cannot guarantee its accuracy and interested parties should rely on their own enquiries.

405/101 Church Street, Ryde