



343/11 Canning Street Lidcombe, NSW



3



2



2

Modern Lifestyle, Perfect Location

OTTO Property presents this near new spacious three bedrooms two bathrooms two car tandem parking open-plan apartment, offering premium lifestyle and convenience. Perfectly positioned next to Sydney Olympic Park's world-class sporting, dining, and retail venues, you'll be impressed by the space, sophistication, and style on offer.

Showcasing a spacious dining and living area which connects to your private balcony, allowing extremely good airflow and lighting into the living area. Your future home comprises three generous sized bedrooms with built-in robes. Your kitchen uses premium stainless steel kitchen appliances and gas cooking.

Features:

- Master bedroom with ensuite
- 3000sqm podium garden with outdoor swimming pool/spa, kids playground, Indoor Gym/Sauna,

Alex Bi

0401 022 086

Daisy Peng

0426 024 148

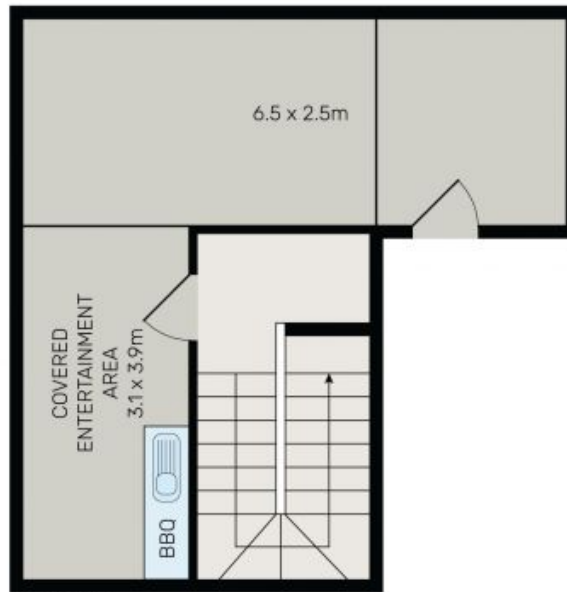

TOP LEVEL



ENTRY LEVEL



All information contained herein is gathered from all sources we believe to be reliable. However we cannot guarantee its accuracy and interested parties should rely on their own enquiries.



343/11 Canning Street, Lidcombe