

342/11 Canning Street Lidcombe, NSW



2



2



1

Modern Living in a Great Location

OTTO Property presents this near new spacious two bedrooms two bathrooms one car parking open-plan apartment, offering premium lifestyle and convenience. Perfectly positioned next to Sydney Olympic Park's world-class sporting, dining, and retail venues, you'll be impressed by the space, sophistication, and style on offer.

Showcasing a spacious dining and living area which connects to your balcony, and both of bedrooms open out to a balcony. The kitchen uses premium stainless steel kitchen appliances and gas cooking.

Features:

- Top floor garden yard with build-in BBQ
- Two large bedrooms, both of them open out to a balcony
- Master bedroom with ensuite
- 3000sqm podium garden with outdoor swimming pool/spa, kids playground, Indoor Gym/Sauna,

Alex Bi

0401 022 086

Daisy Peng

0426 024 148

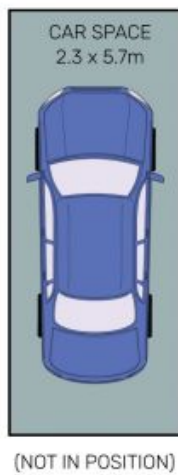
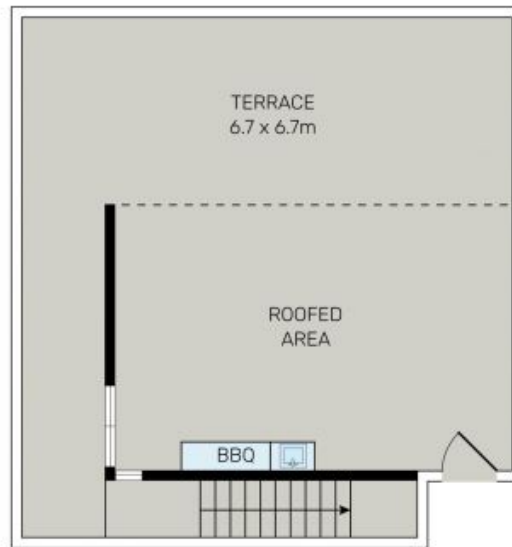

All information contained herein is gathered from all sources we believe to be reliable. However we cannot guarantee its accuracy and interested parties should rely on their own enquiries.



342/11 Canning Street, Lidcombe